

268. Tucker Hall (1899-1900)

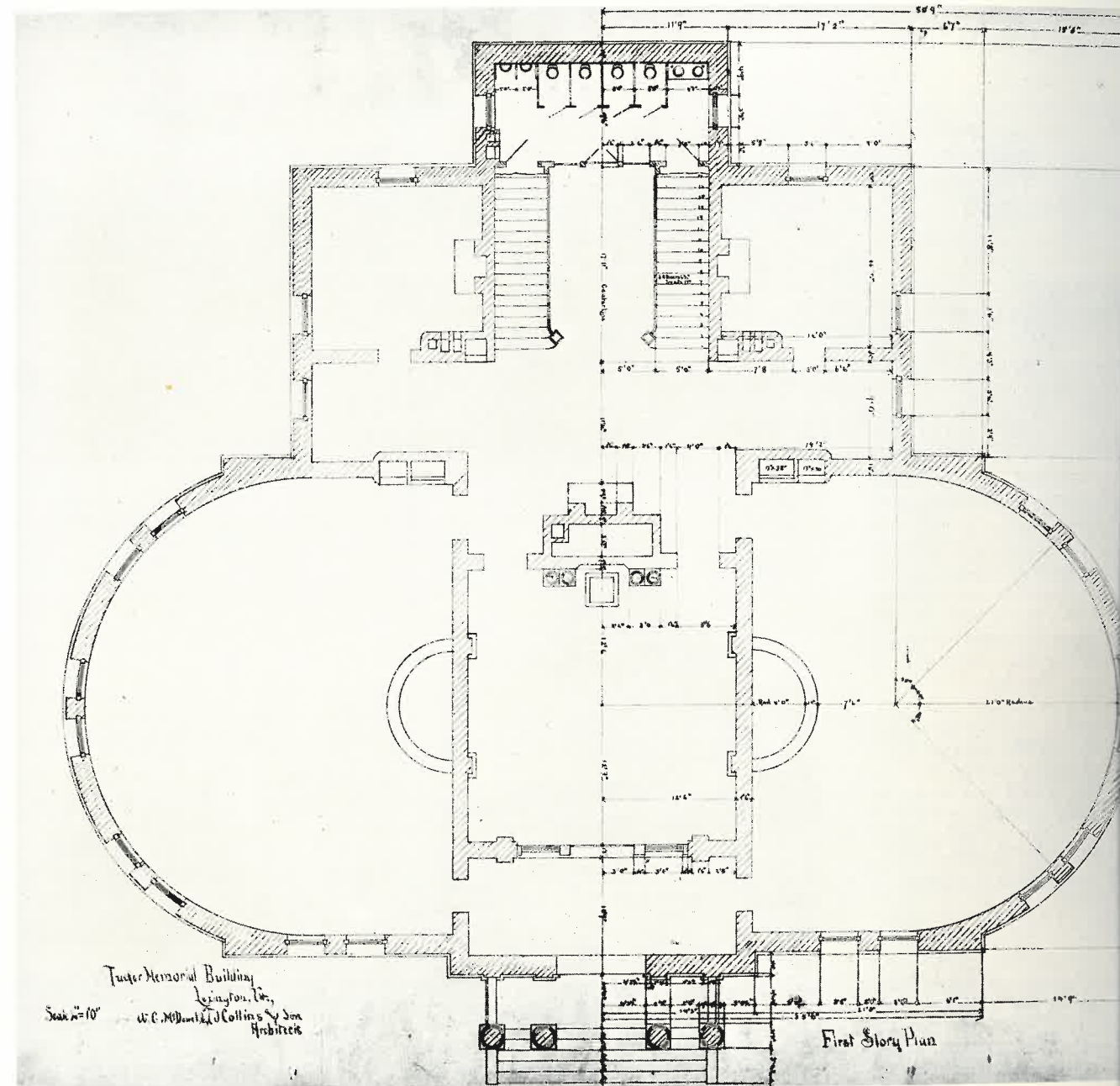

269. Architect's elevation drawing, Tucker Hall

The most impressive building to go up on campus in the 1890s was Tucker Hall, built for the Law School as a memorial to John Randolph Tucker, who had served as professor and dean of the school for fourteen years. The building was designed by local architect-engineer William G. McDowell and Staunton architect T. J. Collins (figs. 268, 269, 270) and was hailed as "an architectural beauty" when it was dedicated in June 1900. By the 1930s, however, this view had changed, and its lack of harmony with the other buildings in the colonnade caused some to see it as an "unsightly mess." It burned early in the morning of December 16, 1934.



270. Floor plan, Tucker Hall